

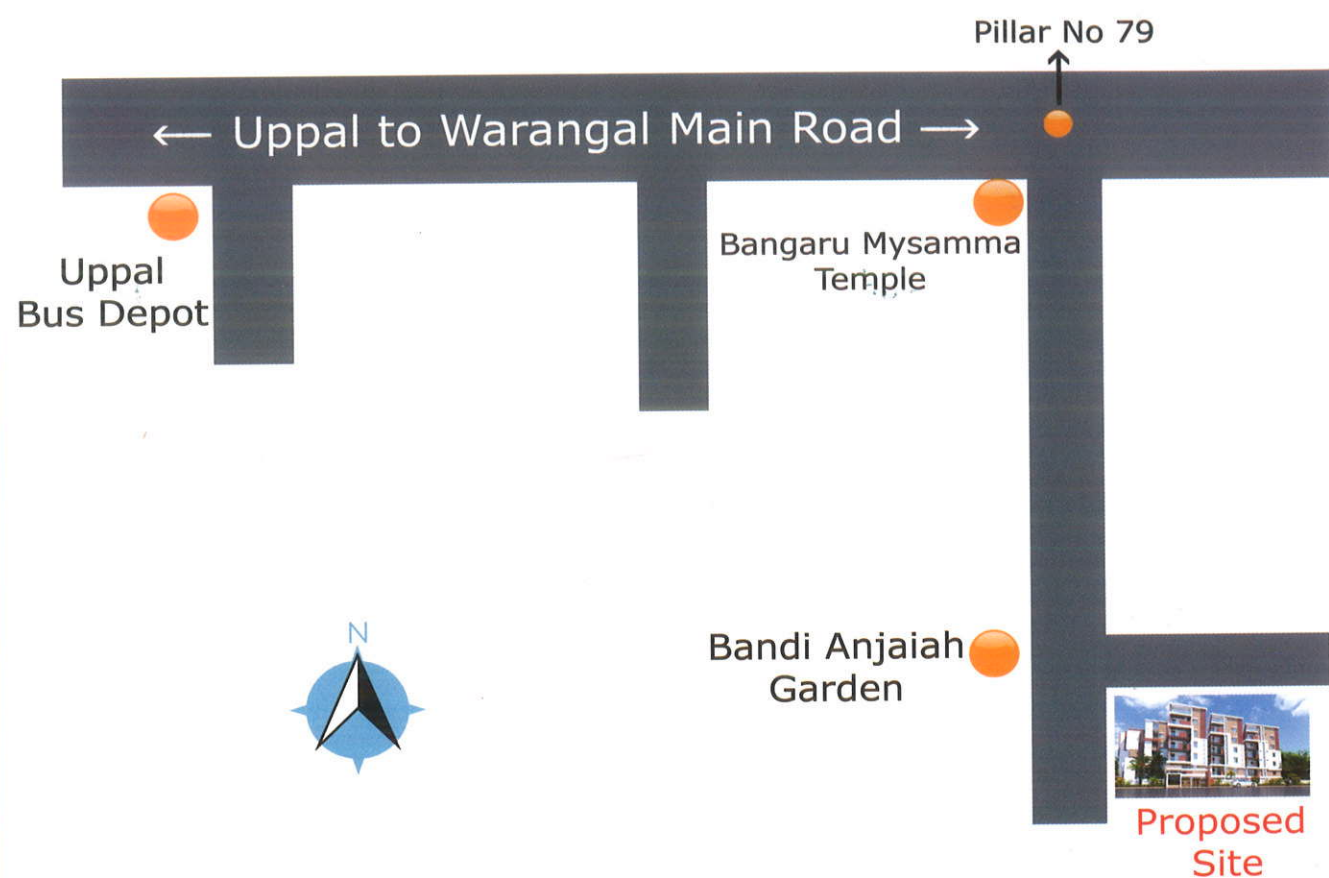

Location Plan

Not to scale



TR's

SKYWAY



The Essence of Pure Living.....!

Promoters :



TR CONSTRUCTIONS

Peerzadiguda, Uppal, Hyderabad
Mobile : 9542792259, 8647929999
9394393939

Consultants:

SAGAR & ASSOCIATES

HYDERABAD
Contact # : 9246366275

.....a prestigious project from



TR CONSTRUCTIONS

NOTE: This brochure is only a conceptual presentation of the project and not a legal offering.

TR's

SKYWAY

RERA
Approved



Project Highlights

- * Green Terrace Garden with Seating Plaza
- * Spacious and Luxury 2 & 3 BHK flats
- * Prime location with major spots nearby
- * 24/7 Power backup for every flat
- * High Quality materials with smooth finishing
- * Safe and secure investment

Typical Floor Plan



Quality of Design Provoke Feelings of **COMFORT** and **GENERATES HAPPINESS**

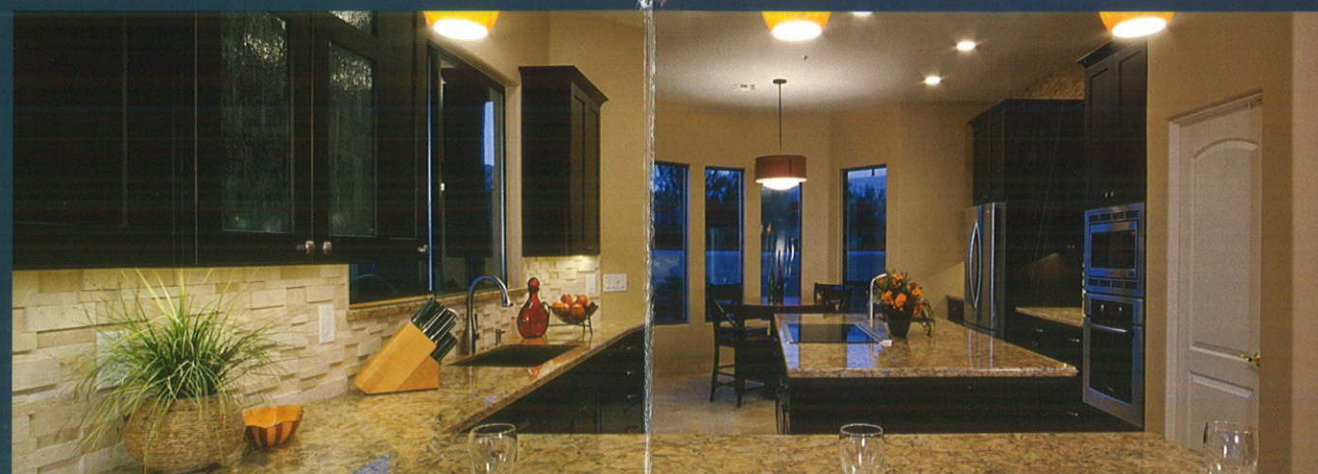
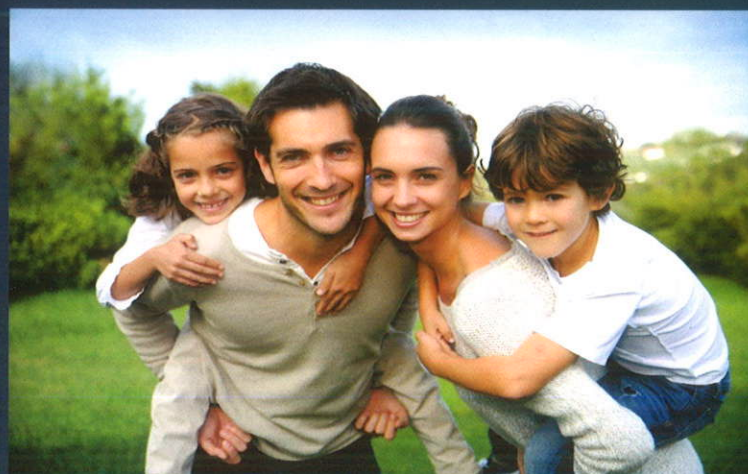

Parking Plan

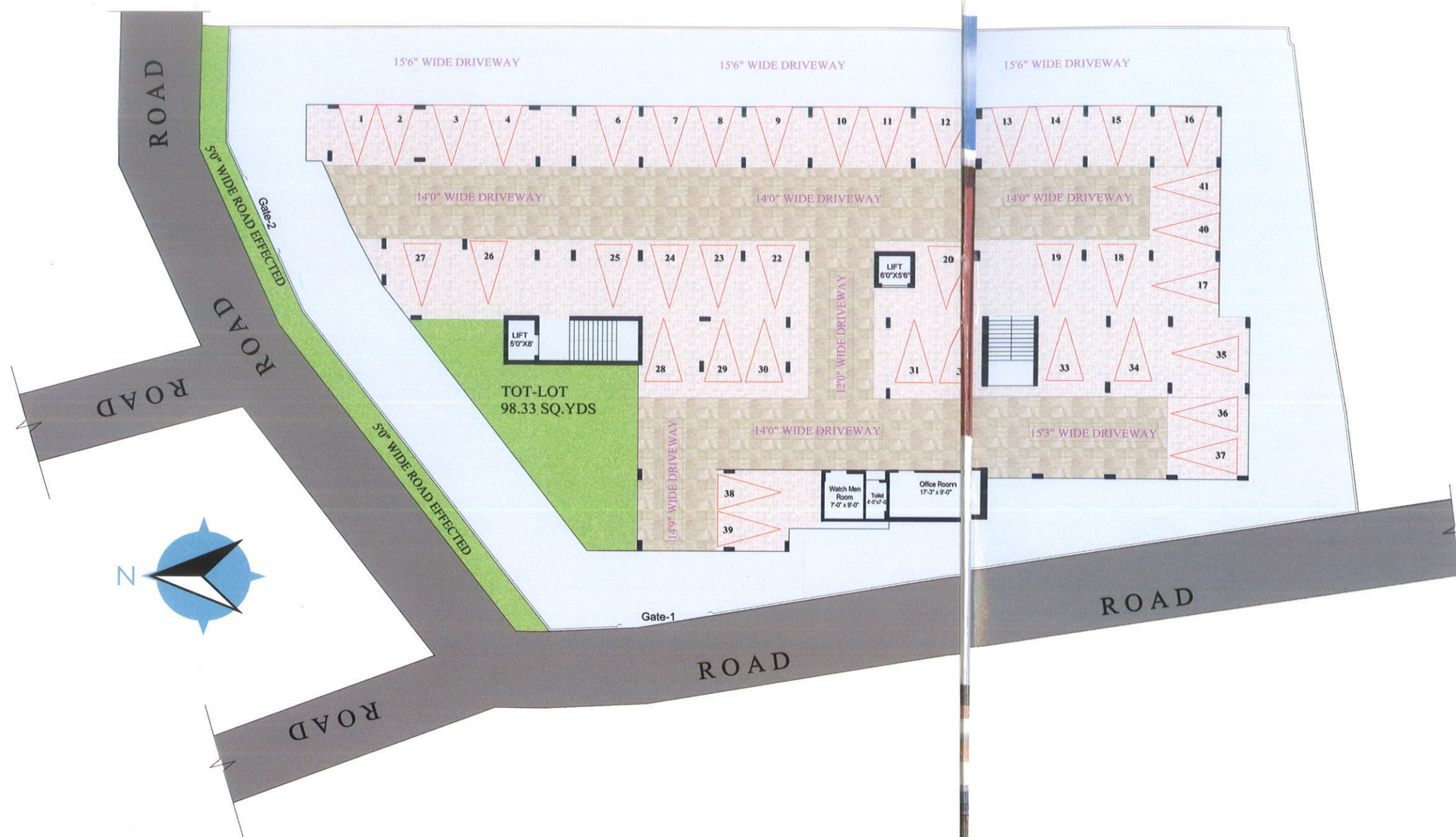

TR's

SKYWAY

Specifications

FRAME WORK:	Reinforced Cement Concrete.
Super Structure:	External walls with 9" thick and internal walls with 4.5" thick with red bricks in cement mortar.
Doors:	Main door with teakwood frames and shutters, designer internal flush doors with teakwood frames, top quality fittings on all doors.
Windows:	UPVC Window Systems. Aesthetically designed M.S. safety grills for windows.
Electrical:	3 Phase Connection with adequate power points & concealed copper wiring.
Flooring:	Vitrified Tiles in Living, Dining and Bedrooms. Anti-skid matt finish tiles in toilets and balcony. Ceramic tiles Dado upto 6' height.
Sanitary:	Concealed pipeline and CP fittings of CERA or equivalent make. Standard fittings and provision for geyser and exhaust fan in toilets. All sanitary fittings are of CERA or equivalent brand fittings.

Plastering:	Smooth finish to internal walls and sponge finish to external walls.
Paint:	Plastic Emulsion with Asian or Nerolac Wall Care Putty on internal walls. Elevation and External finish with Texture paint.
Kitchen:	Granite platform with steel sink, 2' height dado with tiles above the counter. Provision for exhaust fan and suitable electrical points for kitchen appliances. Plumbing provision for both drinking and bore water.
Generator:	All lights and fan points of the Apartment and corridor shall be operating with the Generator during power failure except plug points like AC, Refrigerator, Geyser etc.
Elevator:	Elevator of 6 passengers capacity as planned with standby Generator.
Telephone and TV:	Cable TV points shall be provided in Living and Master Bedroom.
Common Areas:	Corridor and Staircases are with marble or granite flooring and Steel Railing.

Note : Registration, GST and any other Govt. Charges should be borne by the purchaser. Other than the specifications mentioned above will be of extra cost.